



# Apartment , Elisabeth Mill, Elisabeth Gardens, Stockport

£230,000 Leasehold

Lovely two bed apartment in a converted mill

## Description

A LOVELY TOP FLOOR TWO DOUBLE BEDROOM PROPERTY WITH BALCONY AND PARKING SPACE. This property also benefits from an open plan living, kitchen and dining area, a three piece bathroom suite and spectacular views from the balcony overlooking the golf course.

This property is very unique compared to the others in the development of Elisabeth Mill as it is only one of two that comes with a balcony. Also the property has a parking space but there is also an opportunity to rent out another space.

The property is situated in the Stockport area in the converted development of Elisabeth Mill with an array of high specification features such as integrated kitchen appliances, a video entry intercom system plus much more. There are a range of local amenities nearby such as 2 minute walk to the Houldworth Golf Club, 5 minutes from local shopping centre and 10 minutes from Reddish South Station along with several options of public transport links which provide easy access into Manchester City Centre.

## Tenure

Leasehold



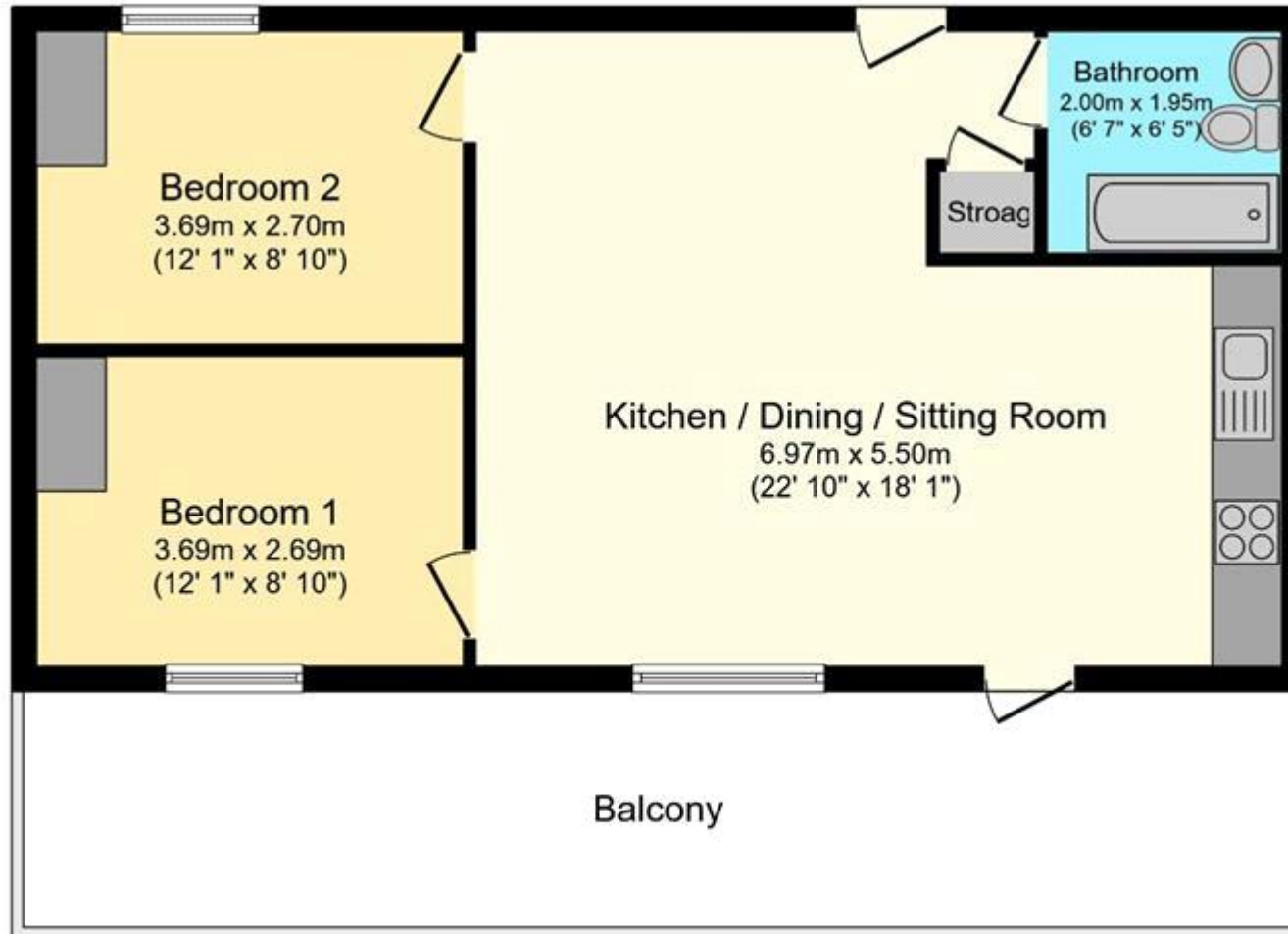

Total floor area 59.1 sq.m. (636 sq.ft.) approx

This plan is for illustration purposes only and may not be representative of the property. Plan not to scale.

Powered by [audioagent.com](http://audioagent.com)



Energy Efficiency Rating		
	Current	Potential
Very energy efficient - lower running costs		
(92-100) <b>A</b>		
(81-91) <b>B</b>		
(69-80) <b>C</b>		
(55-68) <b>D</b>		
(39-54) <b>E</b>	47	47
(21-38) <b>F</b>		
(1-20) <b>G</b>		

Viewing by appointment only  
 NPP Residential - Head Office  
 14 St Mary's Parsonage, Manchester M3 2DF  
 Tel: 0161 639 0050 Email: [info@nppresidential.co.uk](mailto:info@nppresidential.co.uk) Website: