



ELIZABETH GARDENS

Apartment , Elisabeth Mill, Elisabeth Gardens, Stockport

£130,000 Leasehold

New Build Development

Description

A LOVELY ONE BEDROOM APARTMENT ON THE 5TH FLOOR IN THE CONVERTED DEVELOPMENT OF ELISABETH MILL SITUATED IN STOCKPORT. This property benefits from an open plan living room and kitchen area, shower room and spacious one double bedroom.

This property is located in the converted Elisabeth Mill with an array of high specification features such as integrated kitchen appliances, a video entry intercom system plus much more. There is a range of local amenities nearby such as 2 minutes from the Houldworth Golf Club, 5 minutes from local shopping centre and 10 minutes from Reddish South Station along with several options of public transport links which provide easy access into Manchester City Centre.

Tenure

Leasehold



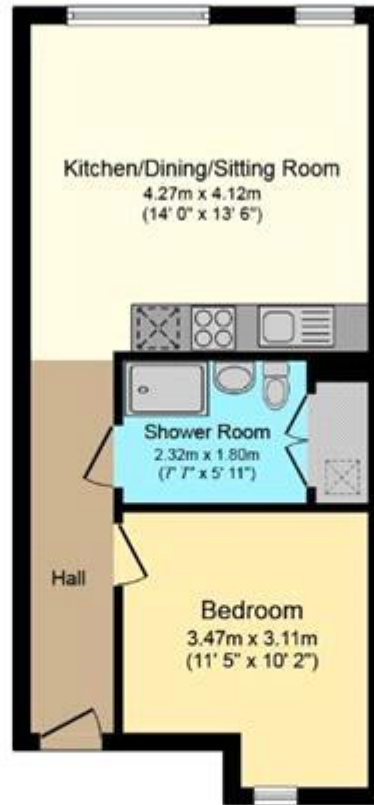

Floor Plan

Floor area 39.1 sq.m. (421 sq.ft.) approx

Total floor area 39.1 sq.m. (421 sq.ft.) approx

This Floor Plan is for illustration purposes only and may not be representative of the property. The position and size of doors, windows and other features are approximate. Unauthorized reproduction prohibited. © PropertyBOX



Energy Efficiency Rating		
	Current	Potential
Very energy efficient - lower running costs		
(92-100) A		
(81-91) B		
(69-80) C		
(55-68) D	64	64
(39-54) E		
(21-38) F		
(1-20) G		

Viewing by appointment only
 NPP Residential - Head Office
 14 St Mary's Parsonage, Manchester M3 2DF
 Tel: 0161 639 0050 Email: info@nppresidential.co.uk Website: