



Apartment , Kelso Place, Manchester

Offers Over £200,000 Leasehold

Two bed apartment

Description

MORTGAGE BUYERS WELCOME Work has commenced to resolve the cladding/fire safety issues but this development has been approved for the governments Building Safety Fund. We have a spacious 2 bed, 2 bath apartment with private balcony on the 6th floor in Block 3 of the popular St Georges Island.

This 5 star development built by Dandara comes with 24 hour concierge, large grounds and is located right on the canal. The city centre is only a short walking distance from the building but you are very close to the Cornbrook tram stop which will give you direct access to all points of Manchester including Trafford Shopping Centre and Manchester airport.

Council Tax Band: D

Tenure: Leasehold (820 years)

Ground Rent: £259.31 per year

Service Charge: £3,075.2 per year

Tenure

Leasehold



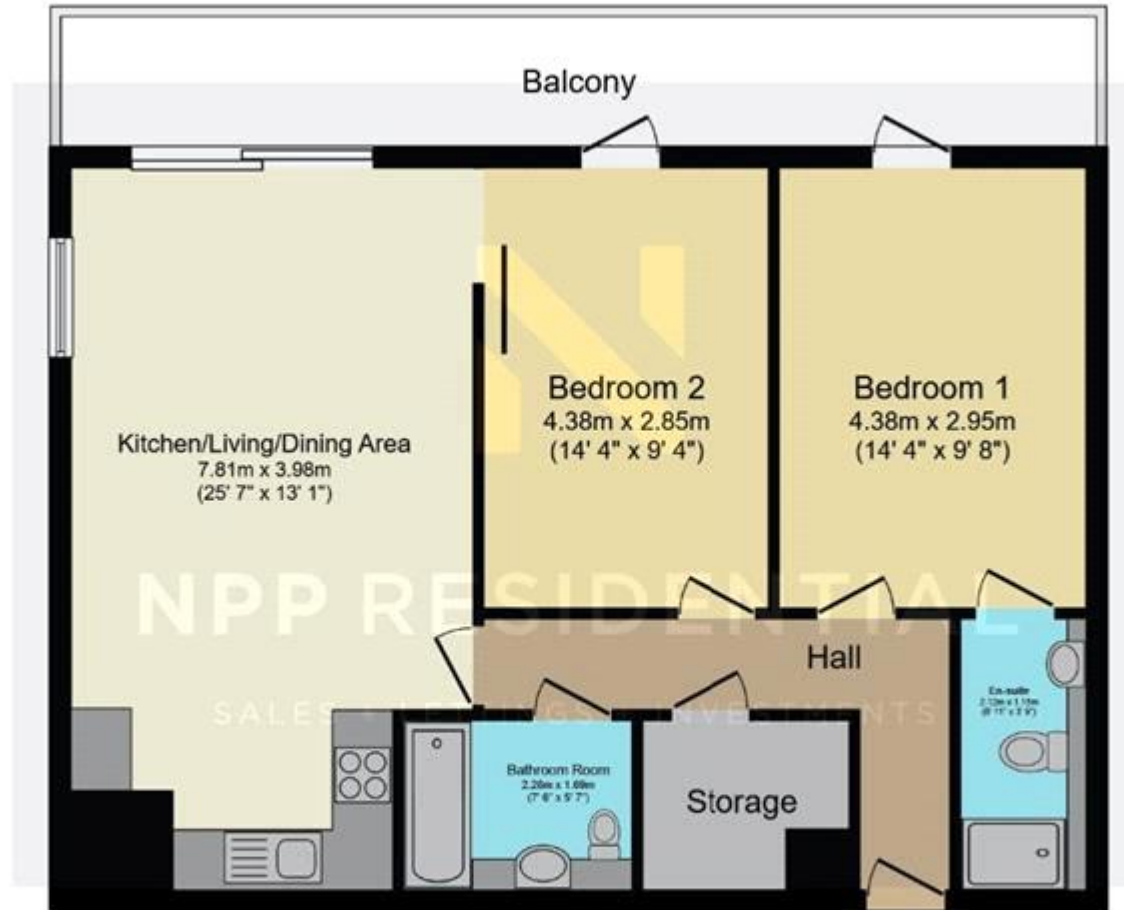

Floor Plan

Total floor area 72.5 sq.m. (781 sq.ft.) approx

This plan is for illustration purposes only and may not be representative of the property. Plan not to scale. Powered by PropertyBox

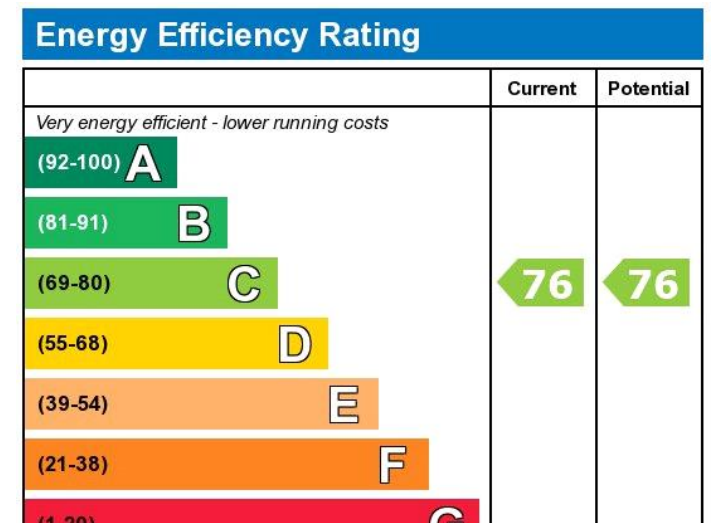

Viewing by appointment only
 NPP Residential - Head Office
 14 St Mary's Parsonage, Manchester M3 2DF
 Tel: 0161 639 0050 Email: info@nppresidential.co.uk Website: <https://nppresidential.co.uk/>