





# Elisabeth Mill, Elisabeth Gardens, Stockport

Offers Over £165,000 Leasehold

2 bedroom apartment

## Description

A LOVELY TWO BEDROOM PROPERTY ON THE GROUND FLOOR IN A CONVERTED MILL IN THE REDDISH AREA. This property benefits from a full open plan living, dining and kitchen area. One double bed room and one single as well as a fully fitted family bathroom.

Elisabeth Gardens is a stunning marriage of history and contemporary living in the heart of Reddish's Houldsworth conservation area. Based just over five miles out of the city centre, Elisabeth Gardens offers the perfect suburban environment for those looking for the advantages of city life whilst remaining out of the hustle and bustle of the central district.

This property is located in the converted Elisabeth Mill with an array of high specification features such as integrated kitchen appliances, a video entry intercom system plus much more. There a range of local amenities nearby such as 2 minutes from the Houldsworth Golf Club, 5 minutes from local shopping centre and 10 minutes from Reddish South Station along with several options of public transport links which provide easy access into Manchester City Centre.

AGENTS NOTE - The photos of the property are marketing photos of the show home.

Council Tax Band: B



Tenure: Leasehold (246 years)

Ground Rent: £149 per year

Service Charge: £1,473.59 per year

## **Tenure**

Leasehold

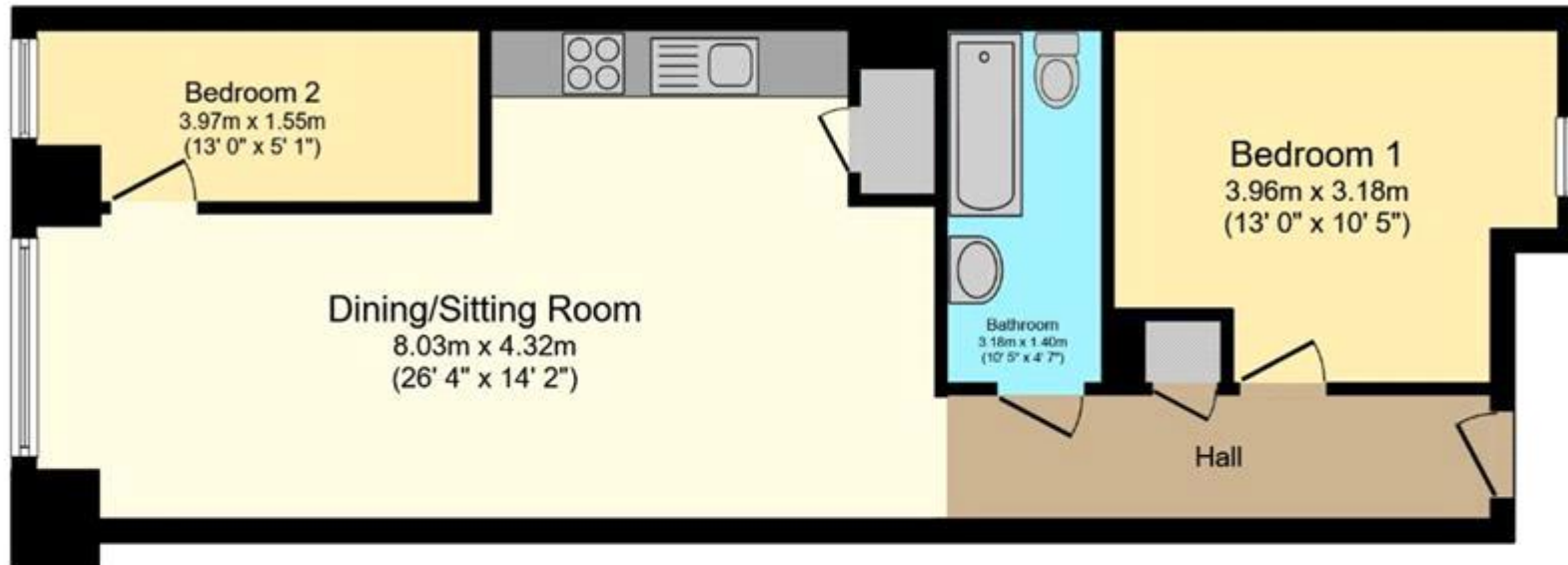

## Floor Plan

Floor area 58.8 sq.m. (633 sq.ft.) approx

Total floor area 58.8 sq.m. (633 sq.ft.) approx

This Floor Plan is for illustration purposes only and may not be representative of the property. The position and size of doors, windows and other features are approximate. Unauthorized reproduction prohibited. © PropertyBOX



Energy Efficiency Rating		
	Current	Potential
Very energy efficient - lower running costs		
(92-100) <b>A</b>		
(81-91) <b>B</b>		
(69-80) <b>C</b>		
(55-68) <b>D</b>		
(39-54) <b>E</b>	<b>43</b>	<b>43</b>
(21-38) <b>F</b>		
(1-20) <b>G</b>		

Viewing by appointment only  
 NPP Residential - Head Office  
 14 St Mary's Parsonage, Manchester M3 2DF  
 Tel: 0161 639 0050 Email: [info@nppresidential.co.uk](mailto:info@nppresidential.co.uk) Website: <https://nppresidential.co.uk/>