





# Elisabeth Mill, Elisabeth Gardens, Stockport

1 bed apartment

£130,000 Leasehold

## Description

A cosy 1-bed apartment on the 5th floor in the converted development of Elisabeth Mill situated in Reddish, Stockport. This property benefits from an open-plan living room and kitchen area, shower room and spacious double bedroom.

This property is located in the converted Elisabeth Mill with an array of high-specification features such as integrated kitchen appliances, a video entry intercom system plus much more.

There is a range of local amenities nearby such as 2 minutes from the Houldsworth Golf Club, 5 minutes from the local shopping centre and 10 minutes from Reddish South Station along with several options of public transport links which provide easy access to Manchester City Centre.

\*Please note pictures are for marketing purposes only, and were taken before the tenant moved in, so each unit may vary\*

Council Tax Band: A

Tenure: Leasehold (244 years)

Ground Rent: £400 per year

Service Charge: £1,016.27 per year

## Tenure

Leasehold





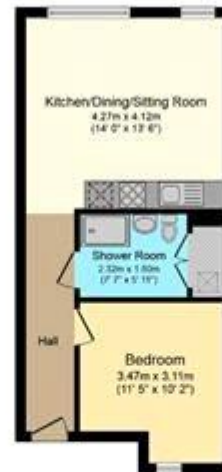

### Floor Plan

Floor area 39.1 sq.m. (421 sq.ft.) approx.

Total floor area 39.1 sq.m. (421 sq.ft.) approx.

This Floor Plan is for indication purposes only and does not constitute a representation of the property. The position and size of doors, windows and other features are approximate. Downloaded from [www.foxtons.co.uk](#) published 10/11/2010 10:10



Energy Efficiency Rating		
	Current	Potential
Very energy efficient - lower running costs		
(92-100) <b>A</b>		
(81-91) <b>B</b>		
(69-80) <b>C</b>	78	84
(55-68) <b>D</b>		
(39-54) <b>E</b>		
(21-38) <b>F</b>		
(1-20) <b>G</b>		

Viewing by appointment only  
 NPP Residential - Head Office  
 22 Lloyd Street, Manchester M2 5WA  
 Tel: 0161 639 0050 Email: [info@nppresidential.co.uk](mailto:info@nppresidential.co.uk) Website: <https://nppresidential.co.uk/>