



Mill Terrace, Elisabeth Gardens

£160,000 Leasehold

1 bed duplex apartment

Description

This 1 bed duplex apartment with parking is situated in the converted development of Elisabeth Gardens in Reddish, Stockport. Benefiting from an open-plan living room and kitchen area, a ground floor WC and storage cupboard. And on the 2nd level a spacious bedroom and bathroom.

This property is located in the beautifully converted Elisabeth Gardens. There are a range of local amenities nearby such as the Houldsworth Golf Club 2 minutes away, 5 minutes from the local shopping centre and 10 minutes from Reddish South Station. Along with several options of public transport links which provide easy access into Manchester City Centre.

With strong rental demand in the area, and a RENTAL YIELD OF 7.4%! This home offers not just a great place to live, but a solid investment opportunity for the future.

****Agent note - photos taken when tenant was living here****

Council Tax Band: B

Tenure: Leasehold (244 years)

Ground Rent: £400 per year

Service Charge: £550 per year

Parking options: Off Street



Tenure

Leasehold



Ground Floor

Floor area 26.8 m² (289 sq.ft.)

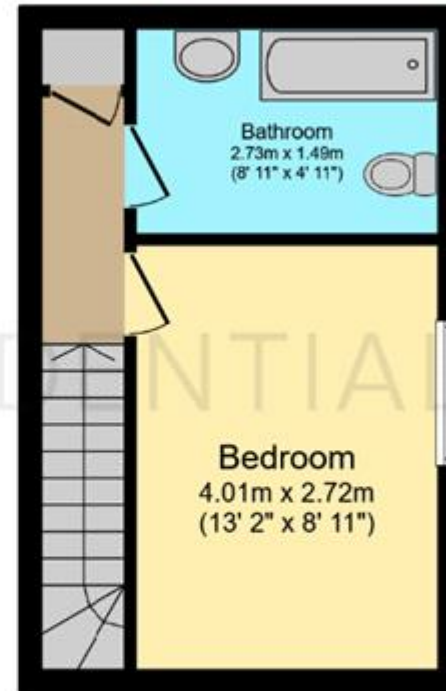

First Floor

Floor area 22.6 m² (244 sq.ft.)

TOTAL: 49.5 m² (533 sq.ft.)

This floor plan is for illustrative purposes only. It is not drawn to scale. Any measurements, floor areas (including any total floor area), openings and orientations are approximate. No details are guaranteed, they cannot be relied upon for any purpose and do not form any part of any agreement. No liability is taken for any error, omission or misstatement. A party must rely upon its own inspection(s). Powered by www.Propertybox.io



Energy Efficiency Rating		
	Current	Potential
Very energy efficient - lower running costs		
(92-100) A		95
(81-91) B		
(69-80) C	79	
(55-68) D		
(39-54) E		
(21-38) F		
(1-20) G		

Viewing by appointment only
 NPP Residential - Head Office
 22 Lloyd Street, Manchester M2 5WA
 Tel: 0161 639 0050 Email: info@nppresidential.co.uk Website: <https://nppresidential.co.uk/>