



Oxygen Tower, Store Street, Manchester

1 bed apartment

£215,000 Leasehold

Description

Designed for comfort and convenience, this one-bed apartment offers an open-concept living area that seamlessly connects to the kitchen. The living area, with its large window fills the space with natural light and provides a welcoming ambiance for relaxation or entertaining.

The kitchen is fully equipped with modern appliances, ample counter space, and stylish cabinetry, making meal preparation a breeze.

The bedroom is a peaceful retreat, complete with a large window for plenty of natural light. The bathroom features contemporary fixtures and a clean, modern design.

Oxygen Tower is a 32-storey neighbourhood in Manchester's popular New Islington district. Located minutes from Piccadilly Station, Ancoats and the Northern Quarter, this is the city's most exciting up-and-coming area.

The building comes with many features including a 24 hour concierge service, a quiet communal area, a cinema room which you can book out for your own private showings, a state of the art 24/7 gym and spin studio and a 25m luxury swimming pool and spa facilities.



****Agent note - photos taken before tenant moved in****

Council Tax Band: B (Manchester City Council)
Tenure: Leasehold (247 years)
Ground Rent: £245 per year
Service Charge: £2,550 per year

Tenure

Leasehold

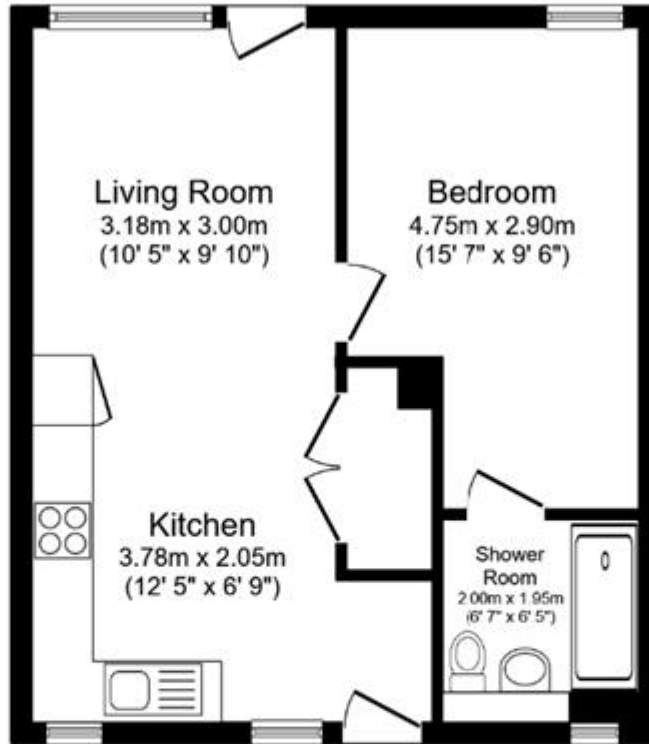

Floor Plan

Floor area 41.1 m² (442 sq.ft.)

TOTAL: 41.1 m² (442 sq.ft.)

This floor plan is for illustrative purposes only. It is not drawn to scale. Any measurements, floor areas (including any total floor area), openings and orientations are approximate. No details are guaranteed, they cannot be relied upon for any purpose and do not form any part of any agreement. No liability is taken for any error, omission or misstatement. A party must rely upon its own inspection(s). Powered by www.Propertybox.io



Energy Efficiency Rating		
	Current	Potential
Very energy efficient - lower running costs		
(92-100) A		
(81-91) B	86	86
(69-80) C		
(55-68) D		
(39-54) E		
(21-38) F		
(1-20) G		

Viewing by appointment only
 NPP Residential - Head Office
 22 Lloyd Street, Manchester M2 5WA
 Tel: 0161 639 0050 Email: info@nppresidential.co.uk Website: <https://nppresidential.co.uk/>