



CHESTER STREET  
MILL MALL HOUSE  
MACHINE COFFEE  
BARBING COCKTAILS

# Church Street, Northern Quarter

Offers Over £195,000 Leasehold

2 bedroom apartment for sale

## Description

(ESTIMATED 8% RENTAL YIELD) A fantastic 2-bedroom, 2-bathroom apartment on the 5th floor of the Pall Mall building in the vibrant Northern Quarter. This stylish home features two double bedrooms, one with an en-suite, an open-plan living and dining area, a modern kitchen, and a family bathroom.

Pall Mall House boasts a grand entrance with original features and provides a lift service to all floors. Enjoy stunning views across the city from the comfort of your apartment.

Set on the iconic Church Street, this development is just a short stroll from Northern Quarter's popular bars, restaurants, and shops. Manchester Piccadilly and Victoria stations are within easy walking distance, as is the Arndale shopping centre on Market Street and Deansgate. Excellent local tram and bus links make getting around Greater Manchester quick and easy.

Council Tax Band: C (Manchester City Council)

Tenure: Leasehold (105 years)

Ground Rent: £200 per year

Service Charge: £1,195.3 per quarter

Service charge includes building insurance & water bill

## Tenure

Leasehold





Approx Gross Internal Area  
76 sq m / 816 sq ft

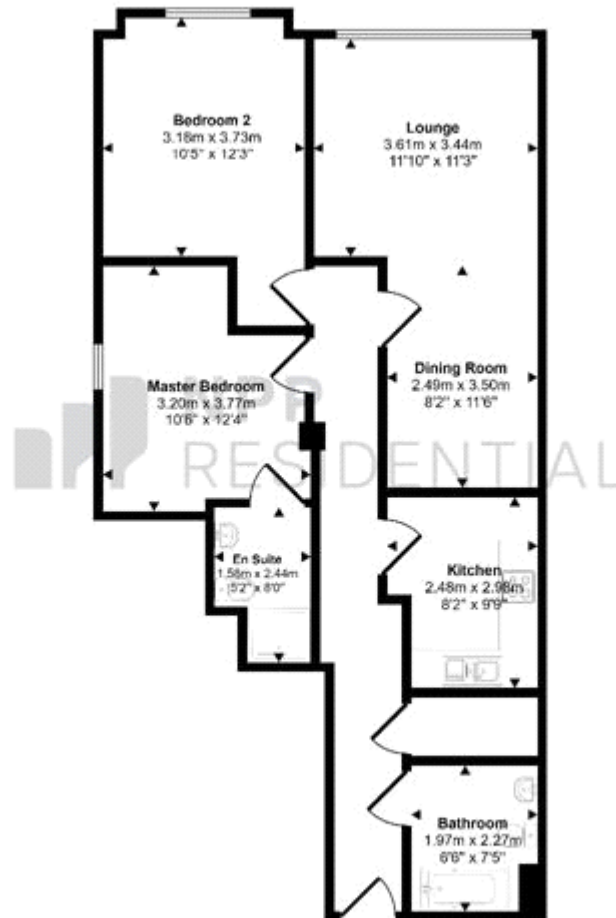

Floorplan

This floorplan is only for illustrative purposes and is not to scale. Measurements of rooms, doors, windows, and any items are approximate and no responsibility is taken for any error, omission or mis-statement. Icons of items such as bathroom suites are representations only and may not look like the real items. Made with Made Snappy 360.

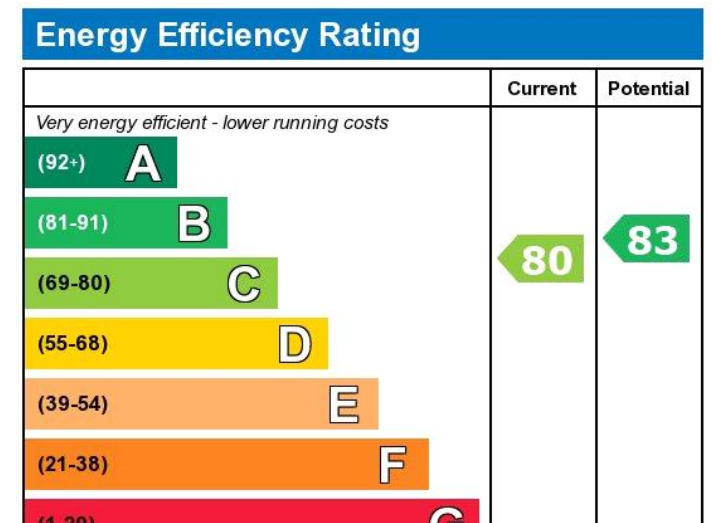

Viewing by appointment only  
 NPP Residential - Head Office  
 22 Lloyd Street, Manchester M2 5WA  
 Tel: 0161 639 0050 Email: [info@nppresidential.co.uk](mailto:info@nppresidential.co.uk) Website: <https://nppresidential.co.uk/>